

JOHNSON COUNTY
KANSAS
Library Annual Report
2024

2024 Annual Report

My library roots run deep, tangled up in stories and curiosity. Growing up with a history and English professor for a mom, books and big questions were part of everyday life.

Joining Johnson County Library in 1998 as the first teen services coordinator, I connected with school librarians, visited classrooms and helped teens find stories that resonated.

As the world around us changes, connecting people with the stories and resources that matter to them means our Library system must be more deeply woven into our communities. To listen. To learn. To serve.

We're rooted in knowledge.

Rooted in progress.

Rooted in community.

Our 2024-2028 Strategic Plan is our commitment to you, reflecting your hopes for today and tomorrow. I'm proud to share our 2024 progress across five Key Performance Areas, emphasizing the people and partnerships that made it possible.

Some accomplishments planted seeds for the future, like engaging the public for input on replacing our aging Corinth branch. Inside Library walls, there was an intense, focused effort as staff helped implement our first organizational restructure in two decades, setting the foundation for more flexible, responsive service.

Other accomplishments came into full bloom. After years of careful planning and cultivation, we closed the historic Antioch Library where we first set down roots in 1956, and on March 20 after more than seven years of planning and construction, we welcomed the public to the new Merriam Plaza branch at the heart of the Merriam Community Center campus.

Day to day, we fulfilled our mission through our 14 branches, millions of checkouts and services reaching far beyond our walls.

Your engagement — as a community member, Library Board member, Foundation supporter, partner or staff — provides the fertile ground for a stronger, more connected Library system in Johnson County.

Like the branches of a tree, our reach keeps growing. And thanks to you, our roots are stronger than ever.



Tricia Suellentrop
County Librarian



Table of Contents

BOARD OF DIRECTORS	4
ADMINISTRATIVE TEAM	5
SUPPORTING ORGANIZATIONS	6
BY THE NUMBERS	11
NEWSWORTHY	12
OUR BRANCHES	14
STRATEGIC PLAN UPDATES	16
CITIZEN SURVEY AND COMPREHENSIVE LIBRARY MASTER PLAN	18
FINANCIALS	19

Key Performance Areas

COMMUNITY

CONVENIENCE

EDUCATION

OPERATIONS

COMMUNICATION

Mission

Johnson County Library provides access to ideas, information, experiences and materials that support and enrich people's lives.

Vision

Johnson County Library creates an environment for people to learn, to explore, to enjoy, to create, to connect.

Values

- Customer needs come first.
- People are respected.
- Access to information is ensured.
- This is a learning organization.
- Freedom of information is protected.
- Privacy and confidentiality are rights.
- Basic services are provided without charge.
- Quality service is important.
- Integrity is a commitment.
- We are stewards of community resources.

On the cover: A mural at Merriam Plaza Library by local artist and Kansas City Art Institute graduate Emily Alvarez weaves together Kansas flora and fauna and a little-known chapter in American racial justice history. The work commemorates the commitment to educational access of longtime Merriam residents Alfonso and Mary Webb. It was funded by Johnson County Government's commitment of 1% of capital project costs to public art.

Alvarez is a professional illustrator whose work has been showcased at the Nelson-Atkins Museum of Art and featured by PBS and NPR.



Board of Directors

The Library is governed by a seven-member, policy-making Board of Directors appointed by the Board of County Commissioners (BOCC) to represent each of Johnson County's six districts and one member appointed by the Chairman of the BOCC. Directors are appointed for a four-year term, and may be reappointed for an additional four-year term. It is a volunteer position. A commissioner from the BOCC is assigned to the Library as liaison each year.

As a policy-making body, the Board makes and adopts rules and regulations. It also employs the County Librarian and owns the property at 13 of 14 Library locations.



BETHANY GRIFFITH

CHAIR MAY 2023
TO APRIL 2024

Appointed by
John Toplikar, District 6

Term expired April 2024



KELLY KILGORE

CHAIR MAY 2024
TO APRIL 2025

Appointed by
Jeff Myers, District 2

Term expires 2025



JENNIFER HRABEC

Appointed by
Shirley Allenbrand,
District 6

Term expires 2028



CHRYSALYN HUFF

Appointed by BOCC
Chairman Mike Kelly,
District 7

Term expires 2028



CHARLES MCALLISTER

Appointed by
Michael Ashcraft,
District 5

Term expires 2027



JEFFREY MENDOZA

Appointed by
Janeé Hanzlick, District 4

Term expires 2026



**LIAISON,
BOARD OF
COUNTY
COMMISSIONERS**

SHIRLEY ALLENBRAND

District 6



DAVID SIMS

Appointed by
Becky Fast, District 1

Term expires 2027



ANNA VAN OPHEM

Appointed by
Charlotte O'Hara,
District 3

Term expires 2025



MITRA TEMPLIN

Appointed by
Former BOCC Chair
Ed Eilert, District 7

Term expired April 2024

Administrative Team



TRICIA SUELLENTROP
COUNTY LIBRARIAN



ADAM WATHEN
ASSOCIATE DIRECTOR
FOR BRANCH SERVICES



KINSLEY RIGGS
DEPUTY COUNTY LIBRARIAN



JENNIFER MAHNKEN
ASSOCIATE DIRECTOR
FOR SYSTEMWIDE SERVICES



PATTI KANGETHE
EXECUTIVE ASSISTANT



DAVID VRATNY
FINANCE DIRECTOR



BENETT SUNDS
ASSOCIATE DIRECTOR
OF CUSTOMER EXPERIENCE



SHELLEY O'BRIEN
FOUNDATION EXECUTIVE
DIRECTOR

Library Board Chair Bethany Griffith cut the ribbon to officially open Merriam Plaza Library on March 20 with 180 guests in attendance.

Pictured left to right are: County Librarian Tricia Suellentrop, Library Board member Jeffrey Mendoza, Associate Director for Branch Services Adam Wathen, 6th District Commissioner and Board Liaison Shirley Allenbrand, Board of County Commissioners Chairman Mike Kelly, Library Board Chair Bethany Griffith, Library Board member David Sims and Associate Director of Customer Experience Ben Sunds.



Supporting Organizations



Volunteers like you help your Library with more than 40,000 hours each year.



Our Friends play an essential part in your successful Library community.

JOHNSON COUNTY
LIBRARY **FOUNDATION**

A gift to the Foundation empowers your Library collections and programs.

Volunteering is a great way for community members to get involved. Volunteers help shelve holds, process donations, assist with genealogy research, set up programs, teach language learners and serve in leadership roles. For every \$1 the Library invests in the volunteer program, the return on that investment is \$9.21. Johnson County Library is grateful for volunteers' support.

\$1,364,349 SERVICE VALUE

- 873 active volunteers • 97 opportunities
- Equivalent to 19+ full-time employees
- 126 volunteers gave 100+ hours of service
- 13 Teen Lifetime Presidential Service Award winners • 40,739 total hours of service in 2024

The Friends of Johnson County Library is a member-supported nonprofit organization promoting community awareness and participation in Library services. They serve as Library advocates, promote literacy and lifelong learning. The Friends of Johnson County Library also make reading materials accessible to all through the sale of gently used, affordably priced books and audio-visual materials. In 2024, the Friends raised an additional \$25,807 to support the collection, Library programs, and county services.

20,000+ VOLUNTEER HOURS

- 895 members • 319 volunteers • 5 staff • 600,000 Library and community book donations accepted
- 63,308 lbs. of books and 6,094 lbs. of cardboard recycled through community recyclers, charity partners, and online book vendors

The Johnson County Library Foundation helps your Library host an outstanding collection of resources, offer programs for patrons of all ages and better serve the needs of everyone in our community. This is done by fundraising and managing donations from individuals, businesses and foundations to support the Library above and beyond what public funding provides. Thus, ensuring the Library's long-term vitality.

OVER \$409,000 IN GIVING

to the Library from the Foundation in 2024

- \$129,536 donation to purchase physical books for the Library collection • \$125,000 donation to Race Project KC from the Kauffman Foundation • \$5,650 donation to the Library for Early Literacy and Teen Programs • \$12,000 for Johnson County Library and Olathe Public Library digital resources • \$14,300 donation for Incarcerated Services

Library Foundation

The Johnson County Library Foundation serves as the Library's fundraising arm, helping ensure its long-term vitality.

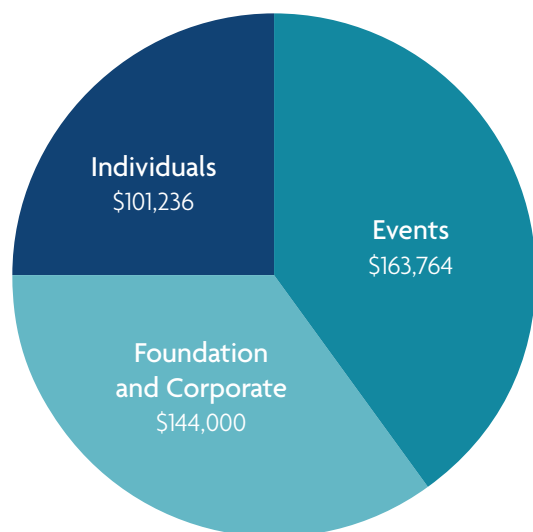

Donations through the Foundation support many high-quality programs and services you see at the Library every day, including:

- New physical books, large print books, and CDs found at all 14 branches.
- New online eBooks and eAudio books through Libby and the Libby app.
- Youth homework assistance from the online program Brainfuse.
- Community engagement programs, including author events and summer reading.
- Early childhood literacy initiatives and activities, including interactive play units.
- Programs like *elementia*, Race Project KC, and the Writers Conference.
- Genealogy services and programming, including the Memory Lab at the Central Resource Library.
- Library services and programming for individuals currently incarcerated in Johnson County.
- The Black & Veatch MakerSpace at the Central Resource Library.

Thank You to All 2024 Donors!

\$10,000 or more

Ewing Marion Kauffman Foundation	Barton P. and Mary D. Cohen Charitable Trust/Midwest Trust, Trustee	Anne & Bill Blessing
Ann K. Baum, G. Kenneth & Ann Baum Philanthropic Fund	Carol & Fred Logan	Louis & Elizabeth Nave Flarsheim Charitable Foundation

\$5,000 – \$9,999

Ian Donahoe	Ann & Bob Regnier, Regnier Family Foundations	Walmart – Multiple stores in Johnson County
Drake Development	Susanne Shutz	David Westbrook
Hope & Tyler Harms	Vickie & Dale Trott	
Michael & Julie Kirk, The Kirk Foundation		

\$2,500 – \$4,999

Chris Anderson & Lyn Buckley	EBSCO Information Services	Johnson County Community College Foundation
Jon & Sarah Baum	Every Henderson Engineers, Inc.	Johnson County Post Menorah Medical Center
Lisa Larson-Bunnell & Nicholas Bunnell	J. Rieger & Co.	R.A. Long Foundation
Michael & Karmel Carothers	Johnson County Bar Association	Stepp & Rothwell, Inc.
		Village Presbyterian Church

\$1,000 – \$2,499

Erwin & Phyllis Abrams	Dysart Taylor	Shelley R. O'Brien
Michael & Renana Abrams	McMonigle Brumitt & Wilcox, P.C.	Kate O'Hara Gasper
William & Maureen Berkley	Janet Filkel	Sarah Page & Drue Kennedy
Judie Black Becker	Josephine Foote	Anjali & Prashant Pandya
Blue Heron Foundation	Patti Greenbaum & Jordan Jurcyk	Mike & Janice Perkins
Mary & Don Bush	Zack & Susan Hangauer	Ann Renne
Campbell Family Foundation	Steve & Kristen Hansen	Kathleen & Michael Riordan
Mark & Sue Carlson	Robyn & Kelly Hart	Nathan & Rachelle Schmachtenberger
CBRE	John & Elizabeth Hjalmarson	Chuck & Kay Sipple
William Chase & Betse Gage	Lundy & Steven Joyce	Burton & Barbara Smoliar
Charles & Virginia Clark	Kansas Family Dental	Julie Steiner
Clark & Enersen	Brad Korris & Missy Bruhn	Greg & Stephanie Stollsteimer
James & Carolyn Clemons, The Cornyn Family Charitable Foundation	Rachel Krantz & Edward Goldstein	Tricia Suellentrop & Shaun Gregory
Country Club Bank	Audrey Langworthy	Nora & Terry Super — Super Family Foundation
Creative Planning, Inc.	Lathrop GPM	Amanda Vega-Mavec & Ethan Mavec
Dake Wells Architecture, Inc.	Pam & Scott Logan	Craig & Liz Wakeman
Dee & Dave Dillon	Bill & Peggy Lyons	Debbie & Terry Westlund
Randall & Helen Duncan	Shamita & Rajiv Mahajan	
	McCownGordon	
	Rick & Denise Mills	
	Marc & Janise Naughton	
	Leigh Anne & Bill Neal	



Library Lets Loose

TOP SECRET:
An Evening of Espionage

Now in its ninth year, the Foundation's signature event and largest fundraiser Library Lets Loose embraced a spy theme complete with secret missions, mysterious prizes and undercover fun. Guests sampled bites and cocktails from 15 local restaurants and bars while dancing to a live DJ, completing spy challenges for prizes and rubbing elbows with celebrity volunteers.

All proceeds supported the Johnson County Library Foundation's mission to expand digital resources like Libby.

Thanks to your sponsorship, the Foundation continues to fund programs and resources that empower Library patrons of all ages.



Supporting Organizations

Business Partners

Andrews McMeel Universal
A-Plus Career & Resume
Bear Necessities Coffee Bar
Dr. Andres Chiropractor
Johnson County Post
Kaplan Test Prep
St. Luke's South Hospital
Tabletop Game and Hobby
Truman Medical Center
The University of Kansas
Health System
We Start Now

Education Partners

4-H Youth Development,
K-State Research and
Extension
50 Plus Program, Lenexa
Parks and Recreation
ACT School
Barstow School
Barton County Library
Bishop Miege High School
Blue Valley Parents as Teachers
Blue Valley School District
Brookridge Day School
Christ Lutheran School
Christ Preparatory Academy
De Soto Parents as Teachers
De Soto School District
Gardner Edgerton
Parents As Teachers
Gardner Edgerton
School District
Goddard School
Growing Futures Early
Education Center
Hiersteiner Child
Development Center
Highlawn Montessori School
Holy Cross Catholic School
Holy Spirit Catholic School
Holy Trinity School
Horizon Academy
Ivy League
John Paul II Catholic School
Johnson County
Community College
Johnson County Community
College Adult Education
Johnson County
Montessori School

K-State Extension Program
Kansas City Academy
Kansas City Christian School
Kansas City Public Schools
Kansas City Public Library
Lee's Summit School District
Legacy Christian
Church Preschool
Literacy KC
Maranatha Christian Academy
Mid-Continent Public Library
Midwest Parent Educators
Mount Olive Lutheran School
Nativity Parish School
Nieman PTA
Olathe Public Library
Olathe School District
Operation Breakthrough
Pioneer Preschool
Premier Learning
Early Childhood
Education Center
Prince of Peace
Catholic School
Rockhurst University
Sacred Heart School
Shawnee Mission
Parents As Teachers
Shawnee Mission
School District
Sonshine Preschool
Special Beginnings Early
Learning Center
Spring Hill School District
St. Agnes Catholic School
St. Teresa's Academy
University of Kansas
University of Missouri –
Kansas City
Wyandotte School District

Municipal and Government Partners

City of De Soto, Kansas
City of Edgerton, Kansas
City of Gardner, Kansas
City of Leawood, Kansas
City of Lenexa, Kansas
City of Merriam, Kansas
City of Olathe, Kansas
City of Overland Park, Kansas
City of Prairie Village, Kansas
City of Shawnee, Kansas
City of Spring Hill, Kansas

Johnson County Department
of Corrections/
Therapeutic Community/
Juvenile Detention Center/
Adult Residential Center/
Sheriff's Office

Johnson County Department
of Aging and Human
Services/Department
of Development
Services/Department of
Emergency Management
and Communications/
Department of Health
and Environment/
Department of Mental
Health/Department
of Technology and
Innovation/Election Office/
Facilities Management/
Human Resources

Johnson County Park
and Recreation/Johnson
County Museum

Kansas Department of Children
and Families

Neighborhood Programs –
City of Overland Park

The Family Conservancy

Partner Organizations

AARP Kansas Tax-Aide
African American Artists
Collective – Kansas City
American Public Square
at Jewell
American Red Cross
Amigos de las Americas
BikeWalkKC
Blue Valley Parks
and Recreation
Boy Scouts of America
Catholic Charities
Center of Grace
Church of the Resurrection
Overland Park
Convent of Christ the King
Daughters of the
American Revolution
De Soto Historical Society
De Soto Rotary Club
El Centro
Evangelistic Center Church
First Baptist Church of Stilwell
Girl Scouts of the USA

Greater Kansas City Hispanic
Chamber of Commerce
GWFC Athena Club of Gardner
Hammerspace Workshop
Housing and Credit
Counseling Inc.

Infant-Toddler Services

InterUrban ArtHouse

Jewish Community Center

of Greater Kansas City

Johnson County and Kansas
City Metro Area Chambers
of Commerce

Johnson County
Genealogical Society

Johnson County Museum

Kansas City Artists Coalition

Kansas City Repertory Theatre

Kansas City Writing Workshop

2026 – Get Your
Writing Published

Kansas Enrichment Network

Kansas Legal Services

KC Digital Drive

KCSOURCELINK

League of Women Voters
of Johnson County

Library Speakers Consortium

Merriam Community Center

MoneySmart KC

National Museum of Toys
and Miniatures

Nelson-Atkins Museum of Art
NCircle

Overland Park

Community Garden

Pets for Life KC

Raising KC

Readers and Writers Network

Redemptorist Social

Services Center

Salem Lutheran Church –
Food Pantry

Seventh-day Adventist Church

Society of Human Resource

Managers –
Johnson County

Sons of the
American Revolution

Strawberry Week Society

The Arts Asylum

Trinity Lutheran Church

Women's Employment
Network

Workforce Partnership



223,721
people have a card
at our
Library

1,869,350
people
walked
through
our doors
in 2024



The
collection
contained
1,042,230
items

The Library was open
40,872 hours in 2024



JOHNSON
COUNTY
LIBRARY

2024
ANNUAL REPORT

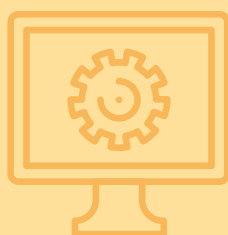

173,310 uses
of public
computers



242,391
Wi-Fi sessions



Print materials
totaled **837,291**



Physical
videos totaled
118,120



Total use
of electronic
materials
1,714,364

Contributing
to a total of
6,900,149
checkouts



We lent our
items to
other
libraries
178,494
times



And brought in
161,824 items upon
patron request



1,689 total
programs offered

51,094 people
attended in total

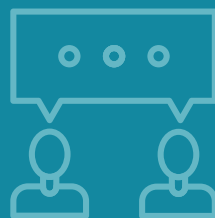

News-worthy



STORYBOOK RELAY

On a sunny Saturday in March, in a symbolic transfer of knowledge, more than 400 neighbors lined up shoulder-to-shoulder to pass the final 50 books from the old Antioch Library to the new Merriam Plaza branch. The quarter-mile chain marked a new chapter filled with community joy.

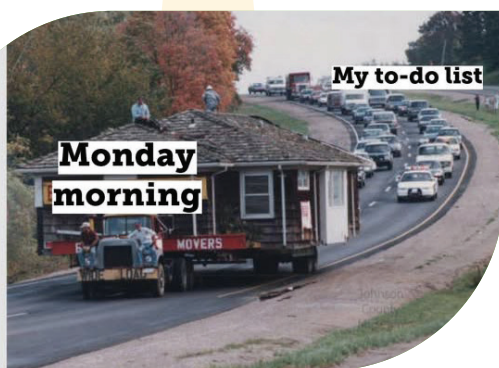

MEME-ORIES

Winter got a dose of LOLs with our Meme Contest, in partnership with Johnson County Museum. Library lovers dug into historic photo archives, added witty captions and battled it out for prizes and internet bragging rights.

DEWEY'S BIRTHDAY

We threw a birthday bash for Melvil Dewey, the man behind the shelf numbers. Without his system, your cookbooks might be cozied up with horror novels. Our viral tribute video had everything for a proper Dewey Decimal Day party: cake, crafts, music, activities and a photo tribute to Dewey himself.

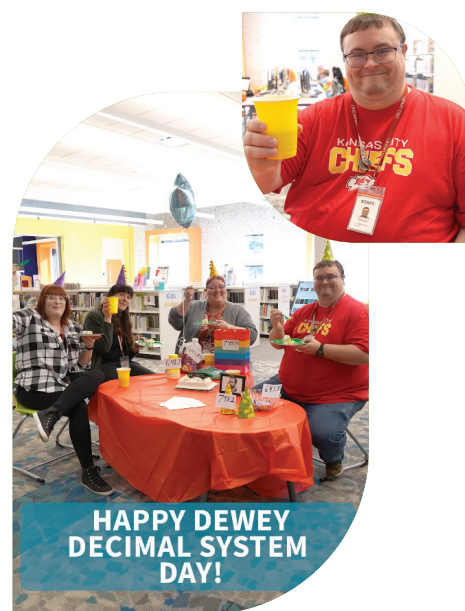

GHOST TREND/GHOSTED

In October, Monticello had a bit of a ghost problem — the friendly, book-loving kind. They floated through the shelves, joined spooky Storytime and enjoyed accordion music. After a full day of haunting, they wrapped things up with a golden-hour read on the terrace. Now that's afterlife goals.

LOOKALIKE

When Patron Services Specialist Tricia Rightmire cracked open "This Is How We Play," she didn't expect to meet her lookalike. "That's why I love how diverse our collection is here," she said. "As many people as possible get to experience the joy of seeing themselves in the pages of a book!"





Merriam Plaza Library Opens Its Doors

At a Glance

Size: 15,000 square feet

Location: 6120 Slater St., Merriam, Kansas

Design Features:

- Large windows and roof monitors for natural light
- Covered porch and outdoor seating
- Eco-friendly green roof
- All-electric

Spaces and Amenities:

- Webb Family Meeting Room
- Two study rooms and a Storytime/meeting room
- Dedicated children's area
- Reservable rooms with wireless A/V
- Drive-thru window for holds pickup and book returns
- Designated petitioning zone

Technology and Services:

- Public computers, copier and printing: (15¢/page, 30¢ double-sided), color (50¢/page, \$1 double-sided)
- Catalog kiosk
- External CD drive
- Free Wi-Fi
- Wheelchair available on-site

Parking:

- Adjacent garage with two electric vehicle charging stations

As the sun rose over Slater Street on March 20, the newest chapter in Johnson County Library history began. With live news crews capturing the moment, Merriam Plaza Library officially opened with a ribbon-cutting ceremony that celebrated community and the promise of what's ahead.

The event included remarks from local leaders, a poem by Poet Laureate of Kansas Traci Brimhall and a moving speech from Victor Webb, the son of Mary and Alfonso Webb, Merriam residents who led a landmark 1949 legal effort to desegregate local schools.

At the heart of the new space is the Webb Family Meeting Room, named in their honor. Their case helped lay the groundwork for the historic Brown v. Board of Education decision. Today, a vibrant mural honors their legacy of equity and education.

"When I'm gone," Victor Webb said, motioning to his grandson, "he can walk in this room, and he will know what we stood for and what we fought for."



Built in partnership with the City of Merriam, the 15,000-square-foot Library sits on the Merriam Community Center campus at 6120 Slater St.

The new facility replaced the beloved but aging Antioch Library, which opened in 1957 as the first official Johnson County Library location. Antioch closed in January 2024 and its staff, and more than 67,000 items, moved a quarter mile down Slater Street to Merriam Plaza.

With its shared campus and wide-ranging amenities, Merriam Plaza Library is a love letter to the community — past, present and future.



Our Branches

Johnson County Library has 14 branches spanning the county offering access to resources that enrich people's lives. Each location is a little different — honoring local history and a sense of place — yet all maintain a common focus on knowledgeable and responsive service.

Cultivating a vibrant Library experience requires thoughtful ongoing investment to keep offerings and buildings current and on pace with patron needs and usage trends.

There is a range of services across the system, including convenient drive thrus, extended hours for hold pickups, community meeting rooms, art displays and public-use PCs and printing. See jocolibrary.org/locations for hours and offerings.

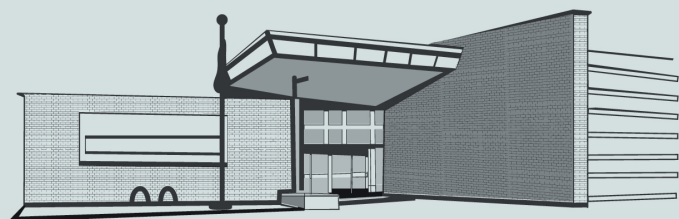

Blue Valley Library

9000 W. 151st Street, Overland Park, Kansas 66221
Opened 1982, relocated 2000

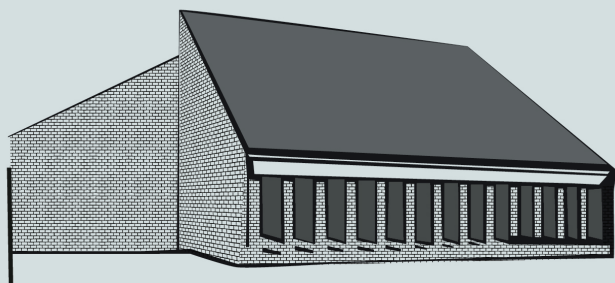

Cedar Roe Library

5120 Cedar Street, Roeland Park, Kansas 66205
Opened 1969, refreshed 2021

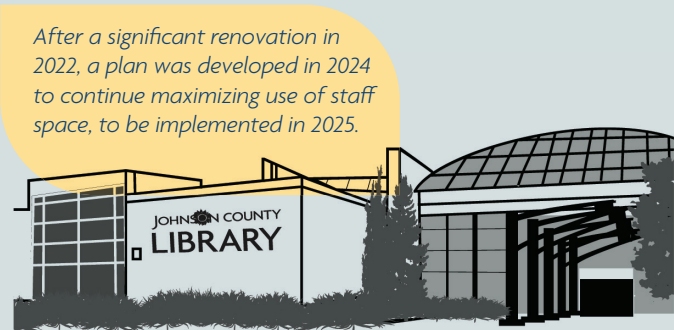

Central Resource Library

9875 W. 87th Street, Overland Park, Kansas, 66202
Opened 1995, renovated 2015 and 2022

As the building nears end of life, replacement options are being explored at the current and alternate locations. In 2024, the Library was part of a study to create a Prairie Village community campus, which did not move forward after a city council vote. The Library continues studying available options.



Corinth Library

8100 Mission Road, Prairie Village, Kansas 66208
Opened 1963, renovated 1988 and 2019

In 2023, building updates to De Soto and Spring Hill were affirmed by the Library Board and Board of County Commissioners. Design requirements were gathered in 2024, with renovations planned in 2025.



De Soto Library

33145 W. 83rd Street, De Soto, Kansas 66018
Opened 1967, rebuilt 1982



Edgerton Library

319 E. Nelson, Edgerton, Kansas 66021
Opened 2000

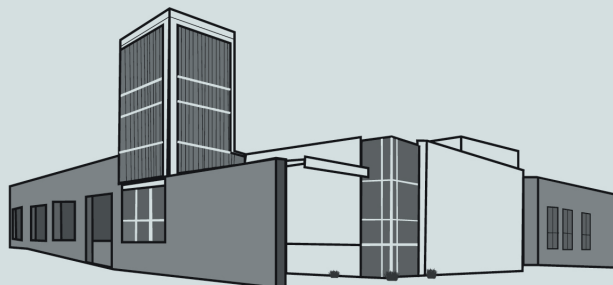

Gardner Library

137 E. Shawnee Street, Gardner, Kansas 66030
Opened 1960, relocated 2001

Our Branches



Leawood Pioneer Library

4700 Town Center Drive, Leawood, Kansas 66211
Opened 1994, refreshed 2009

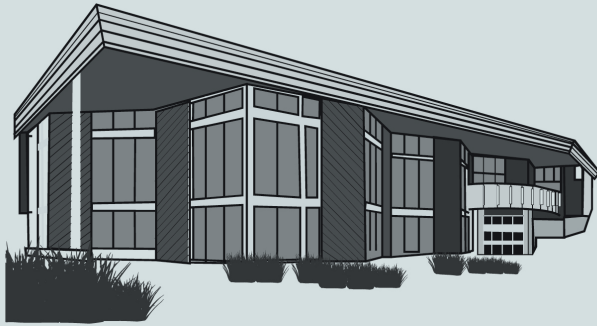

Lenexa City Center Library

8778 Penrose Lane, Lenexa, Kansas 66219
Opened 2019

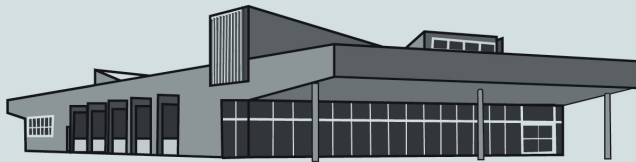

Merriam Plaza Library

6120 Slater Street, Merriam, Kansas 66202
Opened 2024

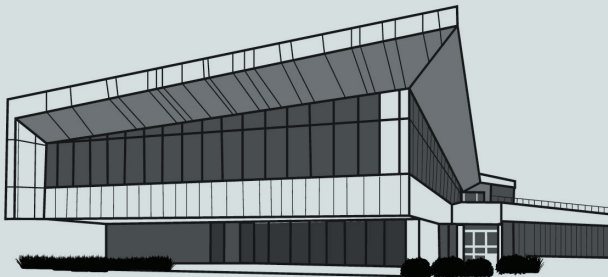

Monticello Library

22435 W. 66th Street, Shawnee, Kansas 66226
Opened 2018

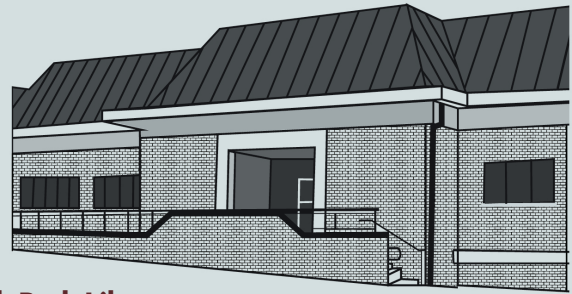

Oak Park Library

9500 Bluejacket Street, Overland Park, Kansas 66214
Opened 1970, expanded 1982, renovated 2023

Major improvements in 2024: upgrades to HVAC and electrical systems, window repair and replacement shelving and furniture.



Shawnee Library

13811 Johnson Drive, Shawnee, Kansas 66216
Opened 1992

Design work for renovation and expansion took place in 2024, with construction planned for 2025.



Spring Hill Library

109 S. Webster Street, Spring Hill, Kansas 66083
Opened 1982

Drawings of the Library's 14 branches were created by staff member Austin Johnson, Library Support Clerk, Circulation Services.

Former Branches Sold, Listed

In summer 2019, Lenexa City Center Library opened, replacing Lackman Library. After exploring other potential uses, in March 2023 the Library Board authorized placing the Lackman property for sale. It was sold in July 2024.

Sale proceeds, after brokerage services fees, went into the Library's reserves with the intent to use for future capital projects.

After Antioch Library closed in late January to prepare for the move to the new Merriam Plaza location, the building and several nearby lots were listed for sale. In December, the Library Board approved the purchase of the property by the City of Merriam.

Strategic Plan Updates

Turning Vision into Action

Our 2024–2028 Strategic Plan ensures that every book we lend, program we offer and decision we make centers on the people we serve. Guided by five key performance areas — Community, Convenience, Education, Operations and Communication — we’re cultivating a Library that meets today’s needs and prepares for tomorrow’s opportunities.



We provide space for civic dialogue and connection.

A Decade of Civil Conversation



COMMUNITY

For 10 years, Johnson County Library has hosted Saturday morning Legislative Coffees — free, nonpartisan events where residents

have access to factual information and are able to meet their elected representatives over coffee and doughnuts.

In 2024, we again partnered with the League of Women Voters to host packed candidate forums and saw record turnout. From Election Day to everyday conversations, the Library remains a trusted space to ask questions and exchange ideas.

“The sessions provide valuable insights into legislative affairs and our elected officials’ positions on various issues in an informal, civil setting.” Ruth Cain, attendee

Last year, Johnson County mom Rachel Van Stratton estimated she saved \$1,400 by using Library resources. She checked out books, audiobooks and eBooks, accessed the internet for grad school applications, learned Spanish and brought her kids to programs — all for free.

“I tell everyone the Library is wonderful because of the community it serves,” she said. “It is such a safe space. It is so helpful.”

From Storytimes to tech tools like 3D printers, the Library is a smart, budget-friendly resource right in your neighborhood.

Save Money, Enrich Your Life



We help patrons stretch their budgets and grow.

CONVENIENCE





A Lifelong Learner



Patrons are empowered to pursue education and career goals.

EDUCATION

In 2024, patrons submitted more than 140,000 print jobs — over half a million pages. From resumes to wedding vows, our upgraded wireless printing system supports flexible payments and works at all 14 branches.

Picture this: 10 minutes before a job interview, you're in the Library lobby, printing from your phone. It works! Quickly and without stress. That's the goal. Reliable, affordable printing when you need it, at just 15 cents a page.

Rachel Audsley has long relied on Johnson County Library for personal and professional growth. She used public computers, internet and printers to apply to graduate school in London, took business courses to advance her career and even taught herself guitar with a small blue book from Central Resource Library.

"All this free information at your fingertips — I don't think people appreciate that enough," she said.

With tools like Universal Class, eResources and eBooks, Audsley has kept exploring her interests and built new skills at no cost.

Today, she helps others do the same as a senior business and community development advocate.

We invest in tools that make everyday tasks easier.



Library Tech That Works for You

OPERATIONS



"It gives me confidence that I'm preparing my child for school and hopefully laying the foundation for loving reading as he grows up..." Laura Miller, parent

For Laura Miller, the Library's 6 by 6, Ready to Read program has been a trusted tool since her son John was a baby. Now three, he still loves the songs from Baby Storytime and exploring themed kit bags.

"They're one of our favorite free activities," Miller said.

"The potty training kit was a great resource!"

She says 6 by 6 has helped her understand and support her child's early literacy skills. "He's just started to notice print everywhere, and it's been so fun to watch that skill develop and help him spot new words and letters."



6 by 6 Reimagined for a New Generation



We're refreshing early literacy with bold visuals and new tools.

COMMUNICATION

Now in its 15th year, the program has a fresh look for a new generation, with updated animal mascots, vibrant visuals and added tools like BookFlix and Talking Books.

"It gives me confidence that I'm preparing my child for school and hopefully laying the foundation for loving reading as he grows up," Miller said.

2024 Citizen Survey

The County's annual Citizen Survey assesses community needs and priorities on behalf of the Johnson County Board of Commissioners. This survey helps the County understand the effective use of resources to provide services that residents want from their county government. Surveys were completed in each of the County's six commission districts in early 2025.

According to the survey, 76% of respondents are satisfied with the quality of County services overall, far exceeding the national average of 49% satisfaction.

Johnson County Library rated in the top five services that residents find most important. These are also the services with the highest satisfaction among respondents.

The Library has the second highest satisfaction rating of County services at 86%. The national benchmark is 46%.

Our community and patrons are important to us, and our dedicated staff works hard every day to earn your trust. Thank you.

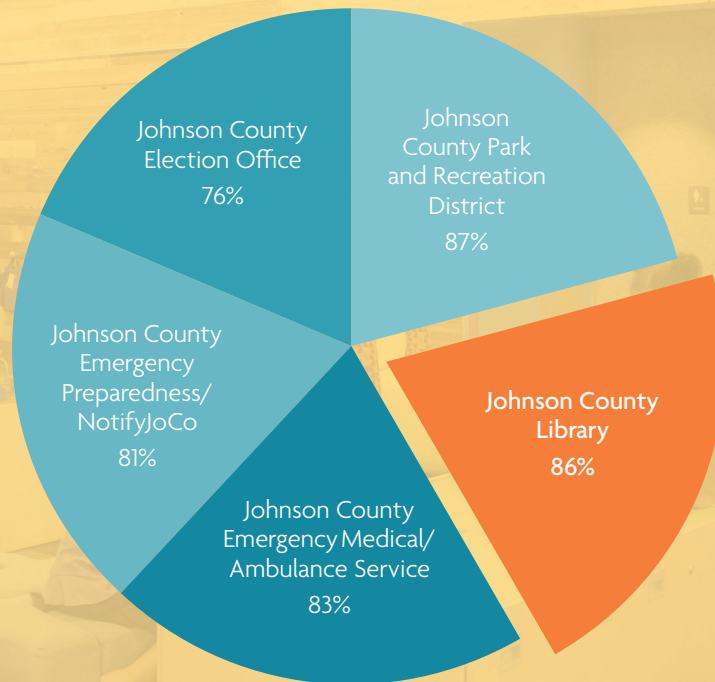

In 2015, Johnson County Library leadership approved the Comprehensive Library Master Plan (CLMP), a framework to guide the Library's sustainable growth of services, operations and facilities for the next 20 years and beyond.

Developed in collaboration with County and Library staff, partners, community members and a team of consultants, the CLMP was guided by data and a deep examination of Library strategic, capital improvement and operations planning documents.

The plan is a tool for remaining flexible and responsive to the changing needs of our community. Now at the halfway point, work on a CLMP review and refresh will get underway in 2025.

A Plan for Guiding Growth

Financials

Revenues FY2024	Actuals
■ Ad Valorem Taxes	\$44,465,187
■ Other Taxes	\$4,124,643
■ Other Library Revenue	\$959,030
■ Grants	\$132,886
■ Investment Interest	\$1,201,115
■ Sale of Capital Assets	\$1,920,768
■ Donations to Gift Fund 1380	\$138,937
Total Revenues	\$52,942,566

<< The ad valorem is a mill levy, a tax rate that is applied to the assessed value of property in Johnson County, excluding Olathe. The Olathe Public Library is supported by Olathe tax payers only.

<< The Johnson County Library Foundation regularly seeks grants to support Library services and programs.

Expenditure Actuals FY2024	Actuals
■ Payroll Expenses	\$26,607,018
■ Contractual Services	\$5,246,587
■ Commodities	\$6,212,321
■ Transfers to Capital Projects	\$10,774,696
■ Lease Payments to Public Building Comm. (PBC)	\$3,606,523
■ Interfund Transfer	\$3,374,464
■ Grant Expenses	\$131,043
■ Risk Management Charges	\$235,055
■ Capital	\$17,987
■ Expenditures out of Gift Fund 1380	\$120,243
Total Expenditures	\$56,325,937

<< By definition, libraries are service-rich agencies that require a broad variety of specially-skilled staff.

<< In 2016, the Library launched a multi-year expansion campaign to build new libraries and to remodel some existing branches.

<< Most grant funds are required to be expended during a defined period. We carefully track these funded projects.

Total Expenditures includes << authorized expense obligations active at year-end 2024.

The 2024 budget included \$6,874,696 in Use of Reserves, providing the ability to spend prior years' unspent revenues. *All figures are rounded to the nearest dollar.

In Funding the Library:

Property tax dollars help fund the Library's budget. Three elements factor into property taxes: appraised value, assessed rate and mill levy rate.

The mill levy rate is the rate at which property is taxed per thousand dollars of assessed value, with three separate taxing districts for:

- Johnson County
- Johnson County Library
- Johnson County Park and Recreation District

Approximately 20% of property taxes go to the County. For a property valued just over \$400,000, near the median for the County, here's what the Library receives:

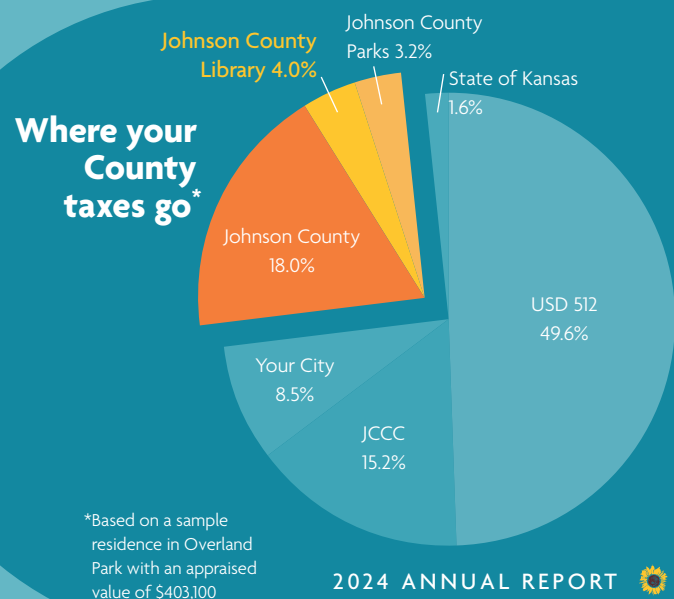



A mural encircling the Webb Family Meeting Room at Merriam Plaza Library depicts lifelong Merriam residents Alfonso and Mary Webb along with their five sons and five daughters, honoring their deep roots in the community.

In the late 1940s, the Webbs, along with several other Black families, filed a lawsuit which laid the foundation for 1954's *Brown v. Board of Education of Topeka* decision outlawing school segregation nationwide.

Their courage and commitment to educational access resonated with Library officials, who are thrilled to share the family's story with future generations through the room's name and mural.